

Meeting Announcement and Agenda
Cambridge Parks, Trails, and Recreation Commission
City Council Chambers
Meeting, Tuesday, November 12 2019
7:00 pm

Members of the audience are encouraged to follow the agenda. Copies of the agenda are on the table outside the Council Chambers door. When addressing the Commission, please state your name and address for the official record.

AGENDA	
1.	<p>Call to Order and Pledge of Allegiance</p> <p>A. Welcome new youth representative Elijah Anderson</p> <p style="padding-left: 20px;">1. Membership Contact List (handout)</p>
2.	<p>Approval of Agenda (p. 1)</p>
3.	<p>Approval of Minutes</p> <p>A. Approval of the August 13, 2019 minutes (p. 3)</p>
4.	<p>Old Business</p> <p>A. Long Range Plan Amendments (p. 8)</p>
5.	<p>New Business</p> <p>A. Veterans Memorial Park (p. 15)</p> <p>B. Resolution in Support of Bonding Money (p. 22)</p> <p>C. Disc Golf Baskets (p. 25)</p> <p>D. Bernick Family Foundation Grant (p. 27)</p> <p>E. Commissioner Quotes & Pictures (verbal)</p>
5.	<p>Other Business/Miscellaneous</p> <p>A. City Council Update</p> <p>B. Commissioner Concerns</p> <p style="padding-left: 20px;">1. City-Wide Park Wi-Fi (verbal)</p>
6.	<p>Adjourn</p>

Notice to the hearing impaired: Upon request to City staff, assisted hearing devices are available for public use.

Accommodations for wheelchair access, Braille, large print, etc. can be made by calling City Hall at (763) 689-3211 at least three days prior to the meeting.

This Page Left Blank Intentionally

**Cambridge Parks, Trails, and Recreation Commission Meeting Minutes
Tuesday, August 13, 2019**

A regular meeting of the Cambridge Parks, Trails, and Recreation Commission was held on Tuesday, August 13, 2019, at Cambridge City Hall Council Chambers, 300 3rd Avenue NE, Cambridge, Minnesota, 55008.

Members Present: Chairperson Mark Ziebarth, Vice Chair Marisa Harder-Chapman, Members Kriste Ericsson, Tom Koep, Council Appointee Mayor Jim Godfrey and Ex-Officio Member Barry Wendorf.

Members Absent: None

Staff Present: Community Development Specialist Carri Levitski.

Call to Order & Pledge of Allegiance

Ziebarth called the meeting to order at 7:01 pm and led the Pledge of Allegiance.

Approval of the Agenda

Godfrey moved, seconded by Harder-Chapman, to approve the agenda as presented. Motion carried unanimously.

Approval of Minutes

Godfrey moved, seconded by Ericsson to approve the July 9, 2019 minutes as presented. Motion carried unanimously.

New Business

Update Priority List

A lengthy discussion took place regarding the priority list and what should be ultimately recommended by the Parks, Trails, and Recreation Commission.

Harder-Chapman moved, seconded by Koep to recommend approval of the following revisions to the Long-Range Plan/Priority List. Motion carried unanimously.

Rank	Improvement	Approximate Cost	Timeline
1	Programs in City Park	<ul style="list-style-type: none"> • Summer Concert Series • Movies in the Park • Activities in the Park \$20,000/year	Annually
2	Spirit River Nature Area	Fat Tire Bike Trails	1-2 years
3	Library	Splash Park (60 x 90) Restroom/Shower/Changing Facility	1-2 years

		Total Cost – Approximately \$660,000	
4	Parkwood Park	Benches \$1,500 Trees \$2,000 Fitness Equipment \$20,000 Wheelchair Swing \$2,000 Horseshoe Pits \$1,000 Shuffleboard \$3,200 Double Swing Set - \$2,100	1-2 years
5	Sandquist Park	Multi-Use Field (Football, Soccer, Lacrosse, etc.) 200' x 300' \$24,000 grading \$9,000 irrigation \$50,000 lighting (optional) Trees	Local Option Sales Tax
6	Central Green	Pickleball Courts \$80,000 Area Association to Raise Between \$12,000 & \$20,000	2020 Street Project??
7	Sandquist Park	\$200,000 – Softball field \$230,000 – Baseball field	5 years
8	C-I Bike/Walk Trail Connection	\$475,000 – paving, gravel, grading, clearing, drainage \$100,000 – easements \$125,000 – engineering, legal, fiscal, permits Total - \$700,000	Local Option Sales Tax
9	Ice Rinks	Dome cover (220' x 105') \$585,000	5 years
10	Pioneer Park	Small Play Equipment \$20,000	5 years
11	Boiling Springs Trail	Undetermined at this point. Potential funding/grant needed for river bank restoration and snowmobile trail/bridge restoration	5+ years
12	Joe's Lake Preserve	Develop Trails \$?	5+ years
13	City Park Future Improvements	\$270,000 – Parking Lot – 60 stall lot (concept B) \$? Acquisition of additional property on Fern Street \$40,000 – Expanded play w/shade canopies \$8,000 – New picnic w/shelter \$10,000 – tot lot	5+ years

Splash Pad Update

Levitski explained preliminary plans were provided by Water Odyssey to demonstrate a possible Splash Pad for residents. The renderings were presented on a board with facts, figures and questions for the public to answer at National Night Out on August 6.

Residents were asked to answer five questions on a sticky note, the questions and consolidated responses of 68 sticky notes are as follows:

1. Would you prefer 1 Larger Splash Pad or a few Smaller ones in different locations?
 - 9 Larger Splash Pad
 - 61 NA

2. Which play features do you like best (based on provided images, see packet)
The Rain Curtain, Under-Brella, Mushroom Maze, Water Cage, Water Flower and Just-A-Bucket were listed as the most desired features. (See Packet)

3. Is having a Splash Pad a high enough priority to spend \$660K?
 - 56 YES
 - 10 NO
 - 2 NA

4. Thoughts on the location? (the board indicated Central Green & the Library were locations already discussed.)
 - 47 NA
 - 8 Central Green Park
 - 7 New Library
 - 2 Pioneer Park
 - 1 AFRC
 - 1 Old Grandview Lot
 - 1 Any

5. Other Comments/Suggestions?
 - 6 YMCA
 - 5 Yes, we are tired of driving far away for splash parks
 - 4 Pool
 - 2 Splash pad and a pool would be better
 - 1 Coon Rapids has a great splash pad
 - 1 Cover the ice rinks and make a pool
 - 1 Get businesses or the school to co-sponsor
 - 1 Have teenagers volunteer and use the swim team for help
 - 1 No one will use it, don't raise taxes
 - 1 Recycle water from the lake and put it at Pioneer Park
 - 1 Too much money
 - 1 We need fun things like this for our families

Levitski reported, residents were asked while waiting in line for hot dogs, chips and root beer floats and many answered only 1 of the 5 questions. The board is being modified to solicit general feedback during Customer Appreciation Day in Downtown Cambridge on September 13th.

Overall the feedback was largely positive, with most responders finding the cost was worthwhile, however, some residents would still prefer a pool, YMCA or combination of all 3 to meet the needs of all age groups and to have something available year-round.

There was discussion as to which park the Commissioners would like to see The Splash Pad constructed. The two locations discussed was Central Greens or the new Library location. The commission felt the Library location would be a safer location and have less vandalism. The Commission discussed concerns about traffic on 95 regards to pedestrian crossing. The Commissioners felt there is no way of getting around 95 traffic in Cambridge and compared it to having the railroad tracks running through town. Commissioners felt moving The Splash Pad to the north side of town would be beneficial, providing an amenity to the north and west side of town. The Commission concurred and ultimately had a consensus where they felt the Library location would be the best location for the splash pad. There were also inquiries as to whether the rest rooms can be included in the construction of the Library project. Staff will research this option.

Summer Parks Program Update

Levitski reviewed the staff report provided by Administrative Assistant Jennifer Cole. Levitski explained the 2019 Summer Parks Program was designed to engage with the community in a variety of ways. The program consisted of Concerts, Movies, Yoga, Arts and a Kids Program. Levitski reviewed each of the programs that were provided to the community which was outlined in the staff report. Commissioners discussed and commented very positively on the summer activities program. The Commission congratulation Ms. Cole on her hard work and successful season for parks programming.

Other Business/Miscellaneous

City Council Update

Godfrey updated the Commission on the last City Council meeting. Approved plans for library.

Commissioner Concerns

Ericsson stated she stopped by the rain garden to take some pictures and commented on how beautiful it looked. She suggested having interpretive signage indicating what is the function of a rain garden.

Levitski gave an update on filling the youth representative position for the Parks Commission. She stated she has been in contact with Cambridge-Isanti High School Principal Dr. Gibbs and they will be working on finding a new youth representative once school is back in session.

Levitski updated the Commission on the organization of a broomball league. Levitski stated she is still working on putting a league together, however, it has been very difficult secure officials.

Levitski updated the Commission on the Disc Golf League and stated the league will be wrapping up on August 19th and has been a very successful season.

Adjournment

Being no further business before the Cambridge Parks, Trails, and Recreation Commission, Wendorf moved, seconded by Ericsson, to adjourn the regular meeting at 8:12 pm. Motion carried unanimously.

Chair Mark Ziebarth
Cambridge, Parks, Trails, and Recreation
Commission Chair

ATTEST:

Carri Levitski, Community Development Specialist

DRAFT

Prepared by: Carri Levitski

Background

It has been brought to staff's attention the Long Range Plan, Priority Ranking and Timeline for Parks Improvements as established by the Parks, Trails, and Recreation Commission must include capital improvements such as major playground and asset replacement.

I have spoken with our Public Works Department and have included the date the equipment and assets need to be replaced per manufacturer's recommendations. The PTR Commission should review the list and incorporate the replacements in the long range plan.

Commission Action:

Discuss and amend the Long Range Plan to include capital improvements as identified in the draft document.

Attachments

1. Long Range Plan
2. Playground Information

November 2019

Long Range Plan, Priority Ranking, and Timeline for Parks Improvements
As established by the Parks, Trails, and Recreation Commission

Rank	Improvement	Approximate Cost	Timeline
1	Programs in City Park	<ul style="list-style-type: none"> • Summer Concert Series • Movies in the Park • Activities in the Park \$20,000/year	Annually
2	Spirit River Nature Area	Fat Tire Bike Trails	1-2 years
3	Library	Splash Park (60 x 90) Restroom/Shower/Changing Facility Total Cost – Approximately \$660,000	1-2 years
4	Parkwood Park	Benches \$1,500 Trees \$2,000 Fitness Equipment \$20,000 Wheelchair Swing \$2,000 Horseshoe Pits \$1,000 Shuffleboard \$3,200 Double Swing Set - \$2,100	1-2 years
5	Sandquist Park	Multi-Use Field (Football, Soccer, Lacrosse, etc.) 200' x 300' \$24,000 grading \$9,000 irrigation \$50,000 lighting (optional) Trees	Local Option Sales Tax
6	Central Green	Pickleball Courts \$80,000 Area Association to Raise Between \$12,000 & \$20,000	2020 Street Project??
7	Sandquist Park	\$200,000 – Softball field \$230,000 – Baseball field	5 years
8	C-I Bike/Walk Trail Connection	\$475,000 – paving, gravel, grading, clearing, drainage \$100,000 – easements \$125,000 – engineering, legal, fiscal, permits Total - \$700,000	Local Option Sales Tax
9	Ice Rinks	Dome cover (220' x 105') \$585,000	5 years
10	Pioneer Park	Small Play Equipment \$20,000	5 years

11	Boiling Springs Trail	Undetermined at this point. Potential funding/grant needed for river bank restoration and snowmobile trail/bridge restoration	5+ years
12	Joe's Lake Preserve	Develop Trails \$?	5+ years
13	City Park Future Improvements	\$270,000 – Parking Lot – 60 stall lot (concept B) \$? Acquisition of additional property on Fern Street \$40,000 – Expanded play w/shade canopies \$8,000 – New picnic w/shelter \$10,000 – tot lot	5+ years

Capital Projects which need to be included in the Long-Range Plan:

Park	Age Range	Date Installed	Date Needing to be Replaced	Appx. Cost
City Park North Swing	All	2004	2020	\$120,000 through 2024
Honeysuckle Park Playground	5-12	2001	2021	
Pioneer Park Playground	5-12	2003	2023	
Brown Park Playground	5-12	2004	2024	
Peterson Park Playground	5-12	2004	2024	
City Park South Small Playground	2-5	2011 (age unknown)	2024	
Sandquist Park Baseball Field Playground	All	2010	2024	
Honeysuckle Park Swing	All	2001	2025	\$120,000 through 2029
Central Green Park Playground	2-5	2006	2026	
Water Tower Park Playground	2-5	2007	2027	
City Park South Large Playground	5-12	2007	2027	
Sandquist Park Softball Field Playground	All	2011 (age unknown)	2028	
Central Green Park Swing	All	2016	2029	
Pioneer Park Swing	All	2003	2030	\$120,000
City Park South Small Swing	All	2004	2030	
City Park North Playground	5-12	2014	2034	
City Park South Large Swing	All	2007	2035	
Water Tower Park Swing	All	2016	2036	
Basketball Court Resurfacing			2036	
Pickleball Court Resurfacing			2036	
Tennis Court Resurfacing			2036	
Bankshot Court Resurfacing			2040	

City of Cambridge Playgrounds



Out of the 18 Cambridge City Parks, 8 contain playground equipment. This document outlines the equipment at each park, including playground installation dates. As we consider the 2020 budget, this detail will help inform any repair or replacement recommendations for existing equipment. Parks containing the oldest equipment are Honeysuckle & Pioneer Parks.

Honeysuckle Park

1100 Honeysuckle Lane S

Park Amenities:

- Playground Ages 5-12 **(installed 2001)**
- Paved Trail w/ lighting
- Benches
- Picnic Table
- Basketball Court
- Tennis Court



Pioneer Park

821 Pioneer Trail SE

Park Amenities:

- Playground Ages 5-12 **(installed 2003)**
- Paved Trail w/ lighting
- Backstop for ball games
- Basketball Court
- Tennis Court



City of Cambridge Playgrounds



Brown Park

905 24th Ave SW

Park Amenities:

- Playground Ages 5-12 **(installed 2004)**
- Paved Trail w/ lighting & benches
- Park shelter
(installed 2010, Eagle Scout Project)
- Bankshot Court **(installed 2018)**



Peterson Park

310 16th Ave SE

Park Amenities:

- Playground Ages 5-12 **(installed 2004)**
- Baseball Field
- Basketball hoop
- Benches
- Picnic Table
- Off street parking



Water Tower Park

255 Birch Street S

Park Amenities:

- Playground Ages 2-5 **(installed 2007)**
- Covered picnic tables
- Benches
- Drinking Fountain



City of Cambridge Playgrounds

Sandquist Park

34262 Naples St NW

Park Amenities:

- Softball Field Playground (**Donation from Cambridge Medical, installed 2011, official age unknown**)
- Baseball Field Playground (**installed 2004 at City Park, relocated to Sandquist in 2014**)
- Baseball Field
- Softball Field
- Soccer / Football Field
- Concessions
- Restrooms
- Outlets



Central Green Park

1455 Fern Street S

Park Amenities:

- Playground ages 2-5 (**installed 2006**)
- Swing set (**installed 2019**)
- Pavilion
- Benches
- Picnic Tables
- 4 Pickleball Courts
- 2 Tennis Courts
- 2 Hockey Rinks
- Warming Houses
- Skateboard Park
- Outlets



City of Cambridge Playgrounds

City Parks North & South

810 2nd Ave SW

Park Amenities:

- North Playground (**installed 2014**)
- North Swing set (**installed 2004**)
- South Large Playground & Swingset (**installed 2007**)
- South Small Playground (**Donation from Cambridge Medical, installed 2011, official age unknown**)
- Playground Ages 5-12 (**installed 2011**)
- Swingset (**installed 2004**)
- Ampitheater
- Picnic Shelters
- Picnic Tables
- Disc Golf
- Four Off Street Parking Lots
- Restrooms
- Volleyball Court
- Basketball Hoop
- Paved Trails
- Fishing Pier
- Benches



Prepared by: Carri Levitski

Background

Representatives from the Veterans Memorial Park will be present to give the Parks, Trails, and Recreation Commission an update on the park progress.

Commission Action:

None

Attachments

1. 2017 Agreement
2. Location Map
3. Site Plan

Agreement
American Legion Memorial Park
207 Birch St. S

THIS AGREEMENT is made this 6 day of SEPTEMBER 2017, between the Howard McCarty American Legion Post 290 (the "Legion") and the City of Cambridge, a public body corporate and politic pursuant to the provisions of MN Statutes §§471.15-471.191 (the "City"),

WHEREAS, the Legion has acquired the property located at 207 Birch St. S. (the "Property") in the City legally described in Exhibit A;

WHEREAS, the Legion wishes to construct certain improvements on the Property, and maintain the property as a Veterans' Memorial Park;

WHEREAS, the City wishes to cooperate with the Legion, and assure that, in the future, the Memorial Park is well-maintained, and an asset to the community;

WHEREAS, the parties hereto have the authority under law to cooperate in establishing and maintaining memorials and recreational facilities.

NOW, THEREFORE, the parties agree as follows:

1. The Legion shall purchase the Property and all improvements upon it.
2. If the Legion dissolves then the property shall automatically be conveyed to the City to be used in perpetuity for Park purposes.
3. The Legion shall prepare sufficient plans as required by the City of the improvements and submit them to the City for review and approval.
4. The Legion shall maintain all improvements on the Property in good repair.
5. The Legion shall pay all utility costs, taxes, insurance, and any other costs related to the Property.
6. Any improvements or alterations made to the Property shall be required to meet State and Federal Building and Fire Codes as well as all applicable City Codes.

7. The Legion shall regularly maintain all lawn area on the Property by mowing and trimming the grass around improvements as needed.
8. The Property shall be used only as a Recreational use of a Non-Commercial Nature in the R-1A zoning district and for no purpose prohibited by the laws of the United States or the State of Minnesota, or of the ordinances of the City of Cambridge.
9. The City agrees to consult with the Legion in its efforts to make the Memorial Park a community asset into the future.
10. This Agreement may only be amended by a writing signed by both parties.
11. This agreement shall be binding on the parties, their personal representatives, successors and assigns.

IN WITNESS WHEREOF, Legion and City have signed this Agreement as of the day and year first above written.

Attest:

Lynda J. Woulfe
 Lynda J. Woulfe
 City Administrator
 Sept - 18, 2017

City of Cambridge

By: Harley A. Palmer
 Its: Mayor
 Date: Sept. 18, 2017

American Legion Post 290

By: Wm. Barber
 Its: Commander
 Date: 9/6/2017

By: Clark Swann
 Its: _____
 Date: 9/6/17

Legion Address:

220 So. MAIN
CAMBRIDGE MN. 55008

Exhibit A

Lots 1 and 4, Block 4, Original Plat to the Village (now City) of Cambridge, EXCEPTING THEREFROM the South 20.2 feet of Lot 4, Block 4, said 20.2 feet being measured along the East line of said Lot 4.

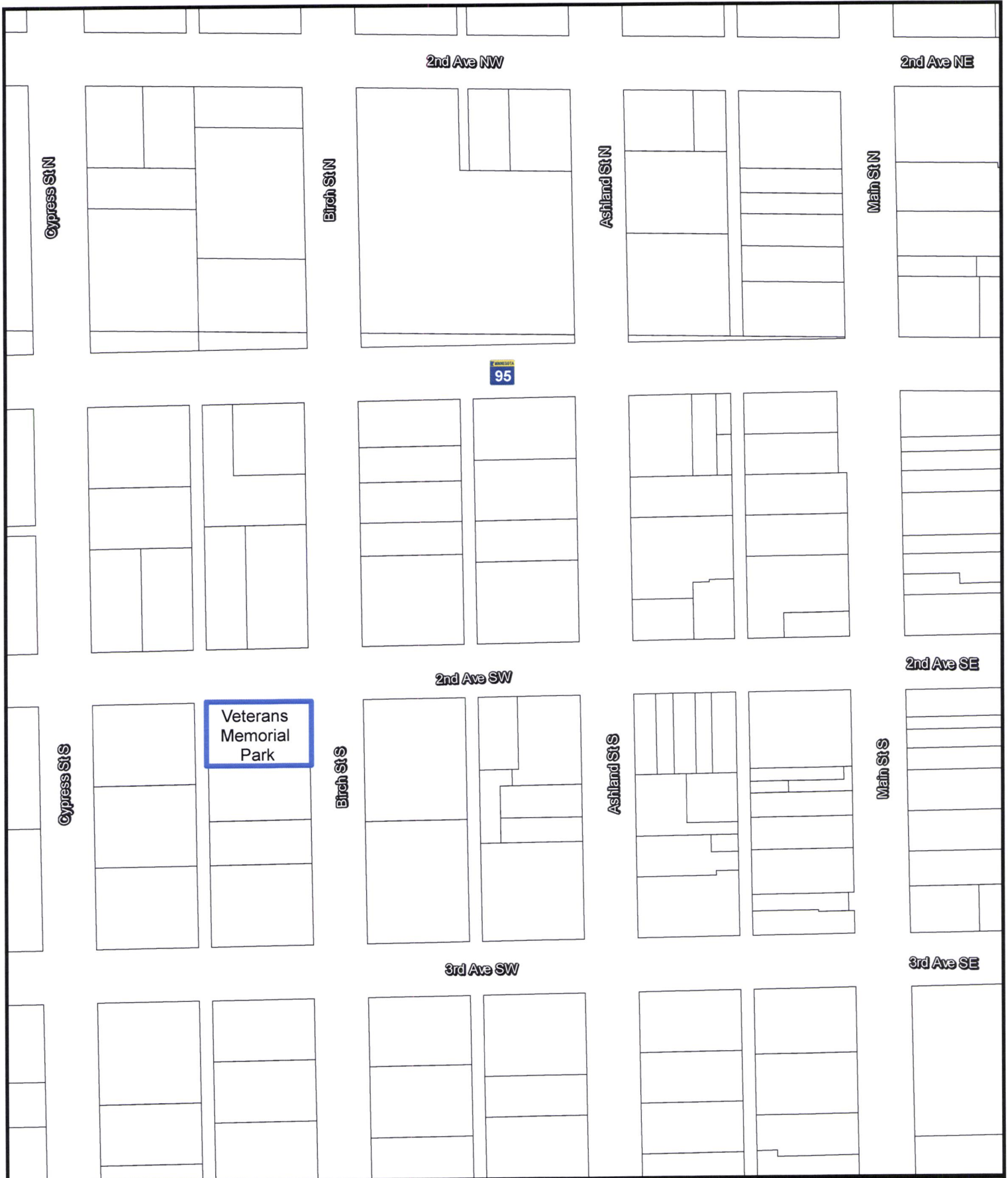

CAMBRIDGE
Minnesota's Opportunity Community®
300 Third Ave NE, Cambridge, MN 55008 ~ 763-689-3211
www.ci.cambridge.mn.us

**Veterans Memorial Park
Location**

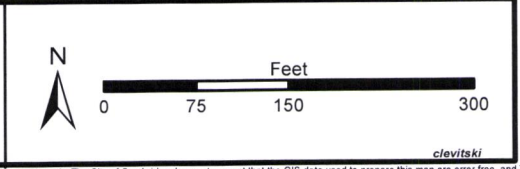

This map is neither a legally recorded map nor a survey map and is not intended to be used as one. This map is a compilation of records, information, and data gathered from various sources and is to be used for reference purposes only. The City of Cambridge does not warrant that the GIS data used to prepare this map are error free, and the data can be used for navigational, tracking, or any other purpose requiring exacting measurement of distance or direction or precision in the depiction of geographic features. The user of this map acknowledges that the City of Cambridge shall not be liable for any damages which arise out of the user's access or use of data provided.



2nd AVE SW

BIRCH STREET SOUTH

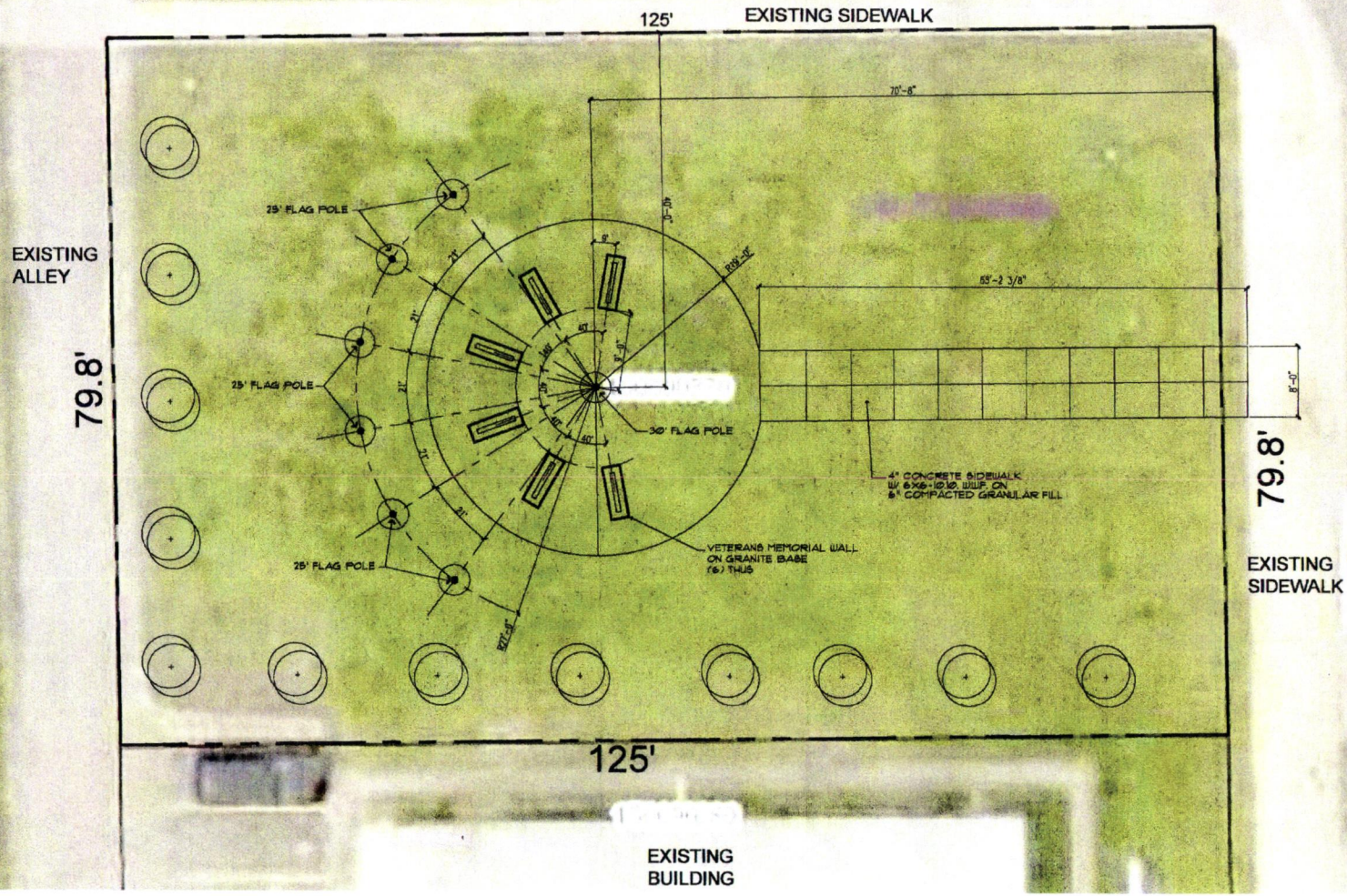

SITE PLAN

1/8" = 1'-0"



NORTH

Prepared by: Carri Levitski

Background

The City of Cambridge is a member of Greater Minnesota Parks and Trails (GMPT). The primary focus of GMPT is to improve the quality of life for citizens of Minnesota by providing areas for recreational opportunities, and promoting legislative support, funding opportunities, and networking for regional parks and trails throughout greater Minnesota.

GMPT is requesting help to encourage the Governor and Legislature to include money for local park and trail grant programs in the 2020 bonding bill. This resolution seeks support for \$4 million in bonding money for the local parks and trails programs created by Minnesota Statute 85.019 which includes the Outdoor Recreation Grant Program and Local/Regional Trail Connection Grant Program.

GMPT has been lobbying hard for these grant programs over the last several years. They were able to restore general fund money for the first time in several decades and have helped the Department of Natural Resources acquire Environment and Natural Resources Trust Fund (ENRTF) money from the Legislative-Citizens Commission on Minnesota Resources. Their efforts have helped secure \$4 million in general fund monies. The programs continue to be oversubscribed and the demand far exceeds the supply which is why they are seeking bonding money.

Commission Action:

Motion to recommend City Council adopt the draft Resolution

Attachments

1. Draft Resolution
2. Minnesota Statute 85.019

Resolution No. R19-XXX

RESOLUTION IN SUPPORT OF BONDING MONEY FOR PARKS AND TRAILS

WHEREAS, parks and trails are an essential park of the City of Cambridge; and

WHEREAS, parks and trails play a vital role in building healthy communities and in attracting much-needed younger workers and families and retaining retirees; and

WHEREAS, recreational opportunities draw in tourists from around the state, region, and nation and recreational spending is a major contributor to state and local economies; and

WHEREAS, according to a George Mason University study, local and regional parks in Minnesota generated an estimated \$2.8 billion in direct, indirect and induced economic activity in Minnesota; and

WHEREAS, local parks and trails recreation grants under Minnesota Statute 85.019 could help the City of Cambridge in the future; and

WHEREAS, many important projects in Greater Minnesota do not qualify for funding under the Legacy Amendment and must look instead to the Minn. Stat. 85.019 programs for funding;

NOW, THEREFORE, BE IT RESOLVED, that the City of Cambridge supports an appropriation of \$4 million in general obligation bonds in 2020 for the Outdoor Recreation, Local Trails Connections and other Minn. Stat. 85.019 grant programs and urges Governor Tim Walz and Lieutenant Governor Peggy Flanagan, and the Legislature to include it in their proposed 2020 bonding bill; and

BE IT FURTHER RESOLVED, that a copy of this resolution be sent to the following: Governor Tim Walz, Lieutenant Governor Peggy Flanagan, Senator Mark Kora, Representative Brian Johnson, Speaker of the House Representative Melissa Hortman, Senate Majority Leader Senator Paul Gazelka, House Capital Investment Chair Representative Mary Murphy, Senate Capital Investment Chair Senator David Senjem, House Environment Finance Chair Representative Rick Hansen, Senate Environment Finance Chair Senator Bill Ingebritgsen, and Department of Natural Resources Commission Sarah Strommen.

Adopted by the Cambridge City Council
This 18th day of November, 2019

James A. Godfrey, Mayor

Linda J. Woulfe, City Administrator

85.019 LOCAL RECREATION GRANTS.

Subdivision 1. **Definition.** For purposes of this section, "unit of government" means a county, statutory or home rule charter city, or town.

Subd. 2. **Parks and outdoor recreation areas.** (a) The commissioner shall administer a program to provide grants to units of government for up to 50 percent of the costs of acquisition and betterment of public land and improvements needed for parks and other outdoor recreation areas and facilities, including costs to create veterans memorial gardens and parks.

(b) For units of government outside the metropolitan area as defined in section 473.121, subdivision 2, the local match required for a grant to acquire or better a regional park or regional outdoor recreation area is \$2 of nonstate money for each \$3 of state money.

Subd. 3. [Repealed by amendment, 1995 c 220 s 68]

Subd. 4. [Repealed by amendment, 1995 c 220 s 68]

Subd. 4a. **Natural and scenic areas.** The commissioner shall administer a program to provide grants to units of government and school districts for the acquisition and betterment of natural and scenic areas such as blufflands, prairies, shorelands, wetlands, and wooded areas. A grant may not exceed 50 percent or \$500,000, whichever is less, of the costs of acquisition and betterment of land acquired under this subdivision. The commissioner shall make payment to a unit of government upon receiving documentation of reimbursable expenditures.

Subd. 4b. **Regional trails.** The commissioner shall administer a program to provide grants to units of government for acquisition and betterment of public land and improvements needed for trails outside the metropolitan area deemed to be of regional significance according to criteria published by the commissioner. Recipients must provide a nonstate cash match of at least 25 percent of total eligible project costs. If land used for the trails is not in full public ownership, then the recipients must prove it is dedicated to the purposes of the grants for at least 20 years. The commissioner shall make payment to a unit of government upon receiving documentation of reimbursable expenditures. A unit of government may enter into a lease or management agreement for the trail, subject to section 16A.695.

Subd. 4c. **Trail connections.** The commissioner shall administer a program to provide grants to units of government for acquisition and betterment of public land and improvements needed for trails that connect communities, trails, and parks and thereby increase the effective length of trail experiences. Recipients must provide a nonstate cash match of at least 25 percent of total eligible project costs. If land used for the trails is not in full public ownership, then the recipients must prove it is dedicated to the purposes of the grants for at least 20 years. The commissioner shall make payment to a unit of government upon receiving documentation of reimbursable expenditures. A unit of government may enter into a lease or management agreement for the trail, subject to section 16A.695.

Subd. 5. **Powers; rules.** The commissioner has all powers necessary and convenient to implement this section, including the authority to adopt rules for the program under chapter 14.

History: 1993 c 172 s 35; 1994 c 643 s 48; 1995 c 220 s 68; 1996 c 407 s 35; 1998 c 404 s 35; 1999 c 231 s 102-104; 2000 c 492 art 1 s 40; 2002 c 393 s 42,43; 2005 c 20 art 1 s 31; 2006 c 258 s 32; 2011 c 107 s 37,38

Prepared by: Carri Levitski

Background

In the past it has been discussed to locate the three-disc golf baskets that staff has on hand at Pioneer Park since there is a large area of open space.

Since the City has started the Disc Golf League, it has been requested that additional baskets are placed in City Park. In speaking with Disc Golf players three baskets at one location will not be the best use of assets.

Staff is looking to see if the Parks, Trails, and Recreation Commission is interested in having these baskets located in City Park to expand the Disc Golf Course instead of locating them in Pioneer Park as previously discussed.

Placement of the baskets in City Park is yet to be determined. I will be meeting with representatives of the disc golf league once we have a spring thaw to see where the best place would be to place the baskets.

Commission Action:

Motion to support the placement of three additional disc golf baskets in City Park.

Attachments

1. Disc Golf Course Layout

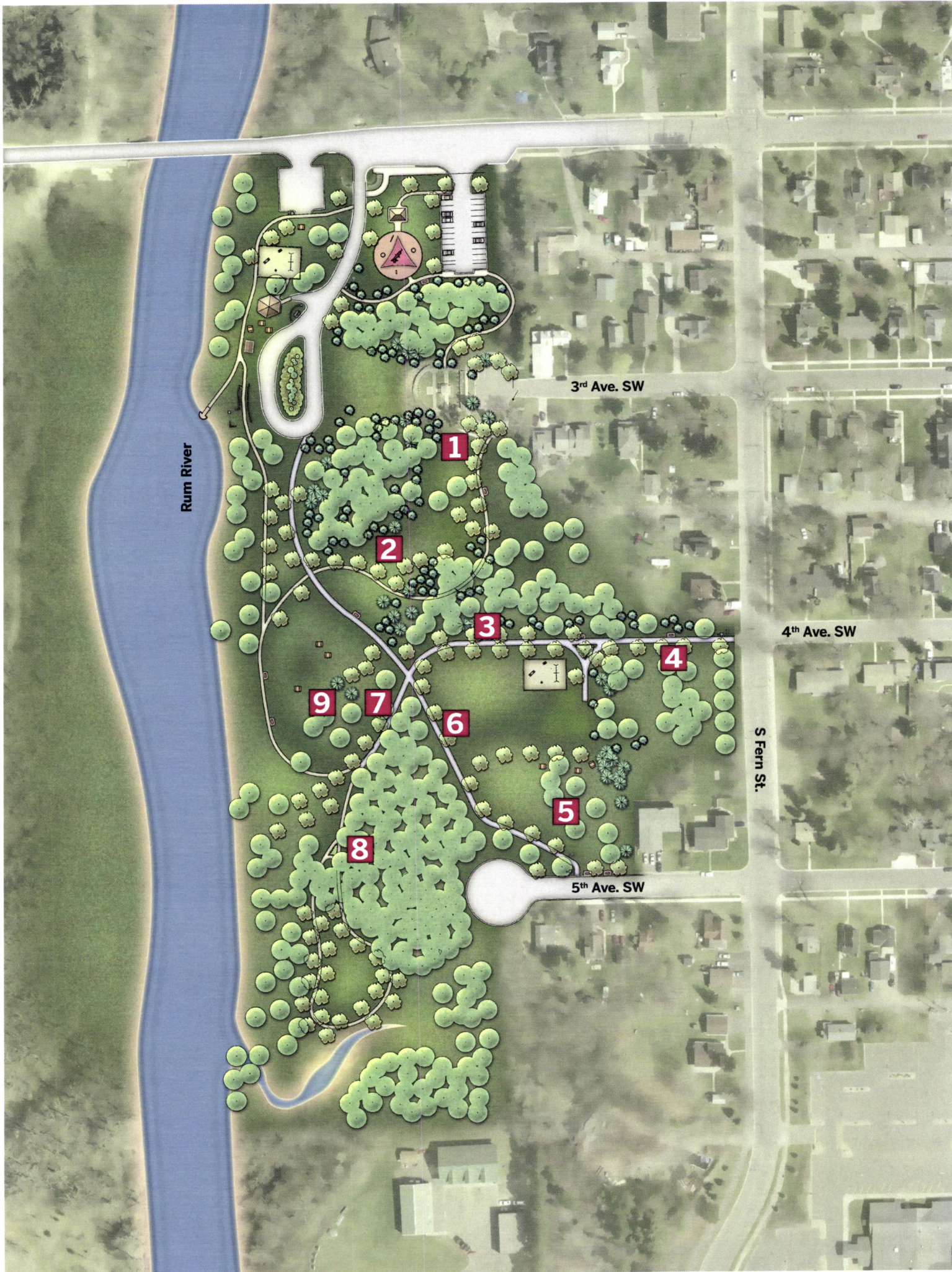

Rum River

3rd Ave. SW

1

2

3

4

4th Ave. SW

9

7

6

5

S Fern St.

8

5th Ave. SW

Prepared by: Carri Levitski

Background

The City of Cambridge submitted a Letter of Intent (LOI) to the Bernick Family Foundation for a grant to begin the development of Parkwood Park. This LOI was the first phase in a two-phase grant application process. In order to actually apply for the grant, the City needed to submit the LOI by August 31st and then be invited to apply for the grant.

The Grants Committee reviewed 74 applications requesting over \$1,827,900. I am happy to announce that at the end of October, I received an email notifying us that the City of Cambridge was selected along with 18 other applicants to complete the full application.

The Bernick Family Foundation will award a total of \$150,000 to several projects throughout the six Bernick regions (Barnum, Bemidji, Brainerd, Duluth, Waite Park, Willmar, and Dresser, Wisconsin). They anticipate grantees will be announced by the end of January. We have applied for \$25,000 in grant monies.

The deadline to apply for the grant is 11:59 pm on Monday, November 11th and staff has completed the grant application and attached it to this staff report. This is a non-matching grant and if selected will help us begin to develop Parkwood Park.

Commission Action:

No action required, information only

Attachments

1. Grant Application

Parkwood Park Improvements

2019-2020 Bernick Family Foundation

City of Cambridge

Mrs. Linda Woulfe
300 3rd Ave NE
Cambridge, MN 55008

clevitski@ci.cambridge.mn.us
O: 763-689-3211
F: 763-689-6801

Mrs. Carri Lee-Villella Levitski

300 3rd Ave NE
Cambridge, MN 55008

clevitski@ci.cambridge.mn.us
O: 763-552-3257
M: 763-464-8798

Application Form

You have been invited to complete the full application for the Bernick Family Foundation Grant.

In this application you will notice that your answers from the Short Application have been moved into this application in a read only format. You will find an additional text box following essay questions; this will allow you to share additional information or any changes that have occurred since you submitted the short application.

If you have questions during this process contact Jeanne, the CommunityGiving Grants and Scholarships Coordinator at
Jblonigen@communityGiving.org or (320) 257 9715

Full Grant Application

Review the grant criteria before you begin. This will include the following:

- Grant Focus Areas and what they will consider funding
- Geographic Area eligibility
- Size of request requirements
- What won't be funded
- Application process

The Grant Description can be found on our website: www.CommunityGiving.org (see the Grants tab)

Hints:

Review grant criteria on the website.

Review all of the application questions prior to starting the application.

Gather the information needed and complete each question thoroughly and concisely.

Save: scroll to the bottom of the form and click the "save" button.

Submit the application when complete: click the 'Submit' Button at the end of the document.

Upload Documents: save each document to your desktop as PDF document.

Bernick Family Foundation

Grant Application:

To ensure that your organization is eligible for this grant and to help you understand the process and timeline for this grant round please review the complete description at:

Bernick Website Description

Funding Request Range: \$3,000 - \$50,000

Grant Period: Mid-February 2019 - February 2020

A total of \$150,000 will be granted throughout the 6 Bernick Service Areas.

Approximately 8-10 organizations, throughout the Bernick Service Area, will be funded.

This grant is a 2 phase process:

- Short application must be submitted; the committee will review all applications.
- The committee will invite approximately 25 organizations to complete the Full Application.

Timeline:

- Accepting Short Applications: July 1- Sept 1
- 1st round status announcement: After Oct 15th
- Full application deadline (only those invited back): November 15th
- Award announcements: approximately Feb 15th

Funding Type

Capital projects
New Program

Eligible organizations

Government entities.

Geographic Area

Waite Park

Focus Area

Health and Fitness

Proposed Project

Project Name*

Parkwood Park Improvements

Amount Requested

\$25,000.00

Organization Information

Mission Statement*

Share the mission statement of the organization.
Either type in the organization mission statement
or

click the Guidestar button and it will upload from your Guidestar profile.

Thus, our mission as the City Council is to create a new and positive sense of community spirit and trust. We will through open government, statutory compliance, and efforts to unite the peoples and businesses of

Cambridge, provide positive leadership to enhance the community image, services and amenities for all of its residents.

Organization Type*

What type of agency is your organization?

Government Agency (including cities and counties)

Organization Activities and Programs*

What services does your organization provide?

Cambridge has approximately 9,000 residents and encompasses special features that set it apart from other communities. The Rum River, a thriving downtown, many city parks, and a Performing Arts Center are just few highlights. Key essential services the City of Cambridge provides includes emergency services (fire, police), administration, finance, community development, public works, and streets.

Cambridge has been striving to meet the ever-demanding need of its residents when it comes to parks, activities, and outdoor recreation. We have an annual art fair, arts in the parks, concerts in the park, youth summer activities, movies in the parks, youth and adult yoga in the parks and many other activities at a low or no cost to our citizens.

An area we are lacking is outdoor fitness and recreational opportunities in our parks. We would like to provide outdoor fitness equipment and additional activities that we currently do not provide at other parks to provide solutions to help our community be more active and combat the health risks associated with sedentary behavior and obesity.

Share the number of staff and volunteers in the organization.

Full-time Staff*

51

Part-time Staff Volunteers

Financial Information

Provide the following information about your organization's budget and financial situation.

In the ATTACHMENTS section, upload a PDF of the most current balance sheet and operating budget.

Previous Fiscal Year Revenue*

Enter Here:

\$6,525,906.00

Previous Fiscal Year Expenses*

Enter here:

\$6,525,906.00

Previous Fiscal Year Net*

Enter Previous Fiscal Year's Net loss or profit

\$0.00

Total Annual Organization Budget*

For Current Fiscal Year

\$6,786,946.00

Total Organization Assets*

Most Recent Quarter

\$142,512,352.00

Fiscal Agency Information - If Applicable

Fiscal Agent Information - ONLY If Applicable

Grants will only be made to eligible non-profits.

If you are NOT a 501c3 and are using a Fiscal Agent, answer the next 4 questions about your Fiscal Agent and Upload a copy of your Fiscal Agent Agreement.

If you are a 501c3 you should NOT complete this section.

Fiscal Agent Organization Name**Fiscal Agent Contact Person****Fiscal Agent EIN Number****Fiscal Agent Agreement**

Upload Fiscal Agent Agreement.
(PDF only)

Project Proposal

Project Summary

From Short Application:

Summary of Project

This is the newest park in Cambridge (Parkwood Park). It is currently undeveloped and the City is looking for assistance to develop the park. It is located in a neighborhood that has mixed uses. This includes the following:

- 50 Unit 55+ Apartment Building (Roosevelt Gardens)
- 103 Unit Apartment Building (The Preserve)
- 69 Unit Assisted Living Facility (Walker Methodist Levande)
- 38 Unit 55+ Condominiums (East Terrace Cooperative)
- 112 Unit Town homes (Parkwood)

41 Detached Town homes
 173 Single Family Homes
 This totals almost 600 dwellings in the immediate area.

There are currently no other parks in the area. The demographics of the residents in this area is incredibly diverse - spanning from workforce housing, families, retirees, and also housing for our aging population needing assistance with living.

Plans for this park include:

Shuffleboard Court
 Horseshoe Pit
 Wheelchair Swing
 Regular Swing set
 Outdoor Fitness Equipment (many pieces are ADA): parallel bars, chin-up stations, push-up station, balance board station, cardio walker, chest press, shoulder rotater, assisted step trainer, and skill trainer.

Executive Summary*

Describe the project to be funded.
 Share how the request fits the guidelines for this grant.

NOTE: Consider answering this question last. This section should summarize the information you share throughout the application.

The total cost to develop this entire park is approximately \$56,680.00. We are hoping to secure this grant to begin improvements on the park since this project is currently undeveloped. This is the only park in the immediate vicinity and will serve approximately 1,548 residents out of 9,000 citizens in Cambridge. The park is adjacent to assisted living facilities, 55+ facilities, multi-family housing along with single family homes and town homes.

This project will directly address active lifestyles and well-being by promoting fitness and engaging residents in recreation and a responsible lifestyle. Unfortunately, the City of Cambridge is still not seeing new residential development projects which is the primary revenue for park development. Because of the economic downturn in the mid-2000's, our park dedication fund has been depleted. While there is not a lot of new development, the demands of our existing residents is on the rise for outdoor recreation. This grant will help us begin a much needed park development which will serve a large population in Cambridge.

Total Project Budget*

Enter the project budget amount here.

The complete project budget will be uploaded in the Attachment section.

\$56,680.00

Activities to be Funded

From Short Application:

Describe the specific activities that would be funded as part of this grant.

The grant will fund equipment costs and site work along with installation of the equipment. If given the opportunity to apply for the grant, formal quotes will be provided as equipment costs fluctuate depending upon the timing of ordering the equipment. We have been working with Minnesota Wisconsin Playground on initial quotes for the equipment.

Activities to be funded: Additional information*

Add additional information as needed

The activities will depend on the total amount funded. If we are granted the entire \$25,000, we will bring the following options to the Parks, Trails, and Recreation Commission to decide which activities will take priority:

- Shuffleboard
- Horseshoe Pit
- Double Swing Set
- Wheelchair Swing Set
- Fitness Equipment to include ADA Chest Press, ADA Parallel Bars, Cardio Walker, ADA Combination Hub, ADA Skill Trainer, Step Trainer, and ADA Shoulder Rotater

Community Needs and Impact

Please address **all** of the following:

- What are the opportunities, challenges, issues or needs in the community that this proposal addresses?
- How will this impact the community and why is it important?

From Short Form:

According to the National Recreation and Park Association, Parks and recreation have three values that make them essential services to communities: Economic Value, Health and Environmental Benefits, Social Importance. Just as water, sewer, and public safety are considered essential public services, parks are vitally important to establishing and maintaining the quality of life in a community, ensuring the health of families and youth.

It is proven that private property values increase the value of privately owned land the closer such land is to parks. This increase in value due to the proximity to parks increases property tax revenues and improves local economies. A Texas A&M review of 25 studies investigating whether parks and open space contributed positively to the values of surrounding properties found that 20 of the 25 studies found that property values were higher. "The real estate market consistently demonstrates that many people are willing to pay a larger amount for property located close to parks and open space areas than for a home that does not offer this amenity."

Parks are the places that people go to get healthy and stay fit. Parks and recreation programs and services contribute to the health of children, youth, adults, and seniors. According to studies by the Centers for Disease Control and Prevention, creating, improving and promoting places to be physically active can improve individual and community health and result in a 25 percent increase of residents who exercise at least three times per week.

What makes this park unique is the diverse demographics it will serve. From young children, to disabled residents, all the way to our aging population and the elderly needing living assistance. Walker Levande has indicated by having a wheelchair swing and ADA fitness equipment, it will encourage their residents to recreate and maintain a healthy lifestyle both physically and emotionally. The regular swing set is a great idea since many families have both disabled and non-disabled children. It will also be great equipment for the elderly with memory issues. We worked with Walker Levande on the type of fitness equipment that will benefit their residents and they are in full support of this LOI. They will also partner with us for equipment check-out for shuffleboard and horseshoes.

The Parks Commission has approved the plan. With the lack of recent development in Cambridge, we do not have park dedication funds, so this grant is much needed.

Community Needs and Impact: Additional information*

Please address all of the following:

- Any changes or updates to the information submitted on the short form .
- How will stakeholders be engaged in the planning, implementation, and success of this project?
- Describe the plan for long-term sustainability of this program.

Stakeholders will be asked which items they would like to be a priority and those items will be forwarded to the Parks, Trails, and Recreation Commission for their consideration.

The long-term sustainability of this program will include replacement of equipment per manufacturers recommendations. The cost of equipment replacement will be included in the City's Capital Improvement Plan.

Building Community*

How will this project encourage people to build new relationships and community connections?

This is a handicap accessible park and an opportunity for people of similar physical challenges to build new relationships. It will also bring the senior and youth community together while targeting families as a whole. Parks are a tangible reflection of the quality of a community. They provide identity for citizens and are a major factor in the perception of quality of life. Parks and recreation is often cited as one of the most important factors in how a community is livable. Parks provide gathering places for families and social groups, as well as for individuals of all ages and economic status and linked to reduction in crime and reduces juvenile delinquency. Parks and recreation programs provide places for health and well-being that are accessible by persons of all ages and abilities, especially to those with disabilities. Parks have a value to communities that transcend the amount of dollars invested. Parks provide a sense of public pride and cohesion to every community.

Recognition

Share the plan to recognize supporters of this project?

From Short Form:

We will work with The Bernick Family Foundation on what they prefer. We will push out a lot of communication on our social media platforms and website. The local papers will write articles. Signage will be placed at the park as well.

Recognition: Additional information*

The City is open to how the Bernick Family Foundation would like us to recognize their generosity. The City of Cambridge has a large social media presence (almost 5,000 followers on Facebook) along with a wide readership throughout the Isanti and Chisago County areas from the two local papers.

Instructions for Goals, Action Steps and Outcomes

INSTRUCTIONS: Goals and Action items

In the next sections, you will share the Project Goals, Action Steps (output), Timeline, and the Anticipated Outcomes (results).

Space is provided for 3 Goals and the Action Items needed to complete the goal. **Each project will vary in how many goals and action items it will need to be successful.** Some projects may have fewer goals, other more goals depending on the scope of the project.

Please use the space you need and leave the remaining goal questions blank.

Goal 1 and the action steps for Goal 1 is required.

Goals and activities should be measurable.

You will be reporting on these goals and activities in your progress and final reports.

Information on Goals:

Goals should be

- Specific
- Measurable
- Time bound

The Activities/Actions should be:

- Specific
- Planned
- Realistic

Timeline:

- Realistic

Goal Example:

Assist 10 young people to learn and practice leadership skills during the next year. They will learn about civic leadership so they can become active leaders in our community.

Timeline, Activities, Outcomes Example:

Activities: *Host 6 monthly group meetings that will include leadership building activities. Each session will include mentoring and an assignment to practice their leadership. (I have included the meeting syllabus as page 1 in the extra file upload.)*

Timeline:

November - December: Recruit and set up meetings;

January - June: Meetings.

July: Follow up meeting/program graduation with students and mentors.

Measure Outcomes:

Each participant will complete a pre-survey and post-survey. Our goal is to have 10 of our 12 students graduate.

Share Goals and Activities and Timelines - Goal 1

Goal 1*

Goal 1: Share a goal.

Help to improve strength, flexibility, endurance, cardiovascular health and blood flow by encouraging residents to utilize outdoor fitness equipment.

Help to reduce and prevent stress, improve self-esteem, confidence, increased sense of exhilaration, adventure, and challenge from life.

This park will strengthen and maintain a healthy community. Recreation brings neighbors together, encourages safer, cleaner neighborhoods and creates a livelier community atmosphere.

Goal 1: Activities and Timeline and Outcomes*

Activities:

Timeline:

Measure Outcomes:

Activities: Work in partnership with local organizations to host events to play shuffleboard and horseshoes. Work with local fitness organization to host fitness classes to introduce the equipment.

*Please note that all timelines will depend on staff workload

Timeline: June 2020: Equipment Installation;

July 2020: Plan Events

August 2020: Host Events

Measure Outcomes: Create an online survey for residents to give feedback on new park improvements; survey to event participants

Goal 2

Goal 2

Goal 2: Share a goal.

Goal 2: Activities and Timeline and Outcomes

Goal 3

Goal 3

Goal 3: Share a goal.

Goal 3: Activities and Timeline and Outcomes

Demographics

Share the anticipated demographics.

NOTE: Grant recipients will be asked to report on the demographics of people served.

Planned Population to Be Served

Example:

Youth grades 4-7 in XYZ School District

Hispanic youth Grades K-12 in ABC neighborhood

Share the population you plan to serve.

This park serves approximately 1,548 people residing in the immediate area. However, the approximate population of Cambridge is 9,000 and parks are open to all residents.

Planned Number to Serve

9000

Attachments

INSTRUCTION:

Uploading PDF Documents

Convert all of your upload documents to PDF documents.

Each section/button only allows 1 file to be uploaded.

These are required documents.

To Upload:

Click the 'Upload a File' button for each requested document.

Select the file from your computer directory to be uploaded and click 'open'.

The file name will appear in blue, and a red x will appear behind the file name. The red x allows you to delete the file.

Organizational Budget*

Upload budget for current year, including income and expenses.

Budget Income and Expenses.pdf

Project Budget*

Include income and expenses.

Please upload the most recent project budget.

Project Budget.pdf

Board of Director List*

Please upload a pdf of your organization's board list

City of Cambridge Council Members.pdf

Additional Funders*

Create a list of additional funders for this project and upload.

Include:

- Organization Name
- Type of funder:
 - State
 - Federal grant
 - Contributions from Individuals
 - Private Funder
- Dollar amounts
- Status: pending or committed

Example:

- *United Way - non-profit grant - \$5,000 - Pending*
- *Otto Bremer Foundation -Private Foundation grant - \$10,000 - Committed*
- *DEED Grant - State Grant - \$10,000 total for 2 years- Committed*

Additional Funders.pdf

Additional Information

Optional Upload

Occasionally, a picture or other document can help the committee better understand the project. Items such as a program outline or other documents can be helpful to convey more about the project.

If this project has such an item, please share here.

LIMIT of 2 pages (8x11) and 3mb.

1 pdf file only

Site Plan.pdf

ELECTRONIC CERTIFICATION IN SUPPORT OF APPLICATION

ELECTRONIC CERTIFICATION

I, the undersigned, on behalf of the charitable organization named above, do hereby certify as follows:

I have the following documents available for review upon request:

- IRS Determination Letter
- Recent Audit *
- Recent 990 *
- Current Financial Documents including Balance Sheet

- Board List

I am an officer, managing employee, or another duly authorized agent for the eligible applicant.*

I Am

The information contained in this application is, to the best of my knowledge and belief, true, complete and accurate.*

I Agree

Should CommunityGiving or its affiliate partners make a grant to the eligible applicant as requested by this application, I acknowledge and understand that such a grant is a one-time grant, and that there is no legal, contractual or moral obligation on the part of the Foundation to make any additional or recurring grants to the applicant at any time in the future, nor is there any expectation or understanding that any such future grants will be made.*

I Understand

Application Authorized Signature*

By typing your name you are electronically signing this document.

You must be an authorized officer of the applicant organization duly empowered to make legal contracts for Grantee.

Linda J. Woulfe

Title*

City Administrator

Date*

11/08/2019

File Attachment Summary

Applicant File Uploads

- Budget Income and Expenses.pdf
- Project Budget.pdf
- City of Cambridge Council Members.pdf
- Additional Funders.pdf
- Site Plan.pdf

Resolution No. R18-092

Resolution Adopting the 2019 General Fund Operating Budget

NOW THEREFORE, BE IT RESOLVED BY THE CITY COUNCIL OF THE CITY OF CAMBRIDGE, ISANTI COUNTY, STATE OF MINNESOTA, that the annual budget of the City of Cambridge for the fiscal year beginning January 1, 2019, is hereby adopted for the General Fund as follows:

GENERAL FUND

Revenues:

Taxes	\$4,701,495
Licenses and Permits	317,360
Intergovernmental Revenues	1,081,241
Charges for Services	123,200
Fines and Forfeitures	42,700
Other	18,600
Transfers From Other Funds	<u>502,350</u>

Total Revenues

\$6,786,946

Operating Expenditures:

General Government	\$1,628,943
Public Safety	2,529,646
Public Works	1,280,498
Parks and Recreation	462,237
Transfers to Other Funds	<u>885,622</u>

Total Operating Expenditures

\$6,786,946

Budgeted Change in Fund Balance

\$0

Adopted this 17th Day of December, 2018.

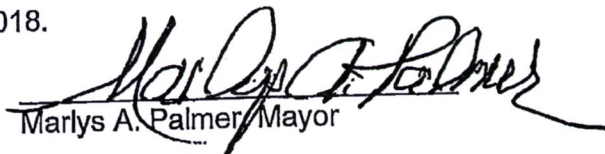
Marlys A. Palmer, Mayor

ATTEST:

Lynda J. Woulfe, City Administrator

Equipment	Use Zone	Cost
Horseshoe Pits	65'x15'	\$ 1,200.00
Shuffleboard	65'x15'	\$ 3,200.00
Double Swingset	25'x40'	\$ 2,700.00
Wheelchair Swing	25'x40'	\$ 3,000.00
Accessible Chest Press	10'x13'	\$ 5,300.00
Accessible Parallel Bars	14'x11'	\$ 1,400.00
Cardio Walker	11'x12'	\$ 4,100.00
Combination Hub	22'x12'	\$ 4,100.00
Accessible Skill Trainer	12'x12'	\$ 2,600.00
Assisted Step Trainer	13'x9'	\$ 3,000.00
Accessible Shoulder Rotater	11'x15'	\$ 3,800.00
Fitness Equipment Install Consultation & Footings		\$ 6,178.00
Concrete Boarder (Shuffleboard)		\$ 4,460.00
Site Work (Edgers & Pins)		\$ 9,642.00
Accessible Fiber Chips		\$ 2,000.00
Subtotal		\$ 56,680.00
Bernick's Family Foundation Grant		\$ 25,000.00
Total Funds Still Needed to Complete Park		\$ 31,680.00



205 Boring Drive • Dalton, GA 30721
 t: 800 540 4899 • f: 706 529 0849
 www.versacourt.com

Estimate

Date	Estimate #
7/24/2019	12633

VersaCourt is a proud member of the RG family of companies



Bill To

Carri Levitski
 300 3rd Ave NE
 Cambridge, MN 55008
 USA
 Carri-(763)552-3257

Ship To

Carri Levitski
 300 3rd Ave NE
 Cambridge, MN 55008
 USA
 Carri-(763)552-3257

Ship VIA	CSR	Payment Terms	Rep
Best Way	Jimmy Walker	Prepaid	067

Quantity	U/M	Description	Sidemark	Total
		Game Outdoor Tile Required Slab Size: 8'11" x 47'9" Court Size: 8'9" x 47'7"		
		Court Kit: S-9 Type: Shuffleboard - Single Size: 8'9" x 47'7" Court: Royal Blue Border: White Shooting Area: Royal Blue Ramps: White Corners: White Includes 1 set of Shuffleboard Lines		2,608.48T
1	ea	Deluxe Fiberglass Shuffleboard Set Includes Acro Disc & Alum Scoreboard (2 boxes)		230.39T
1		Shipping- Court		306.33
1		Shipping- SHuffle Board Set		51.38
		Will drop ship from vendor		
		Total sales tax calculated by AvaTax		0.00
		Select this as a transaction's tax to use AvaTax		0.00
			Total	\$3,196.58

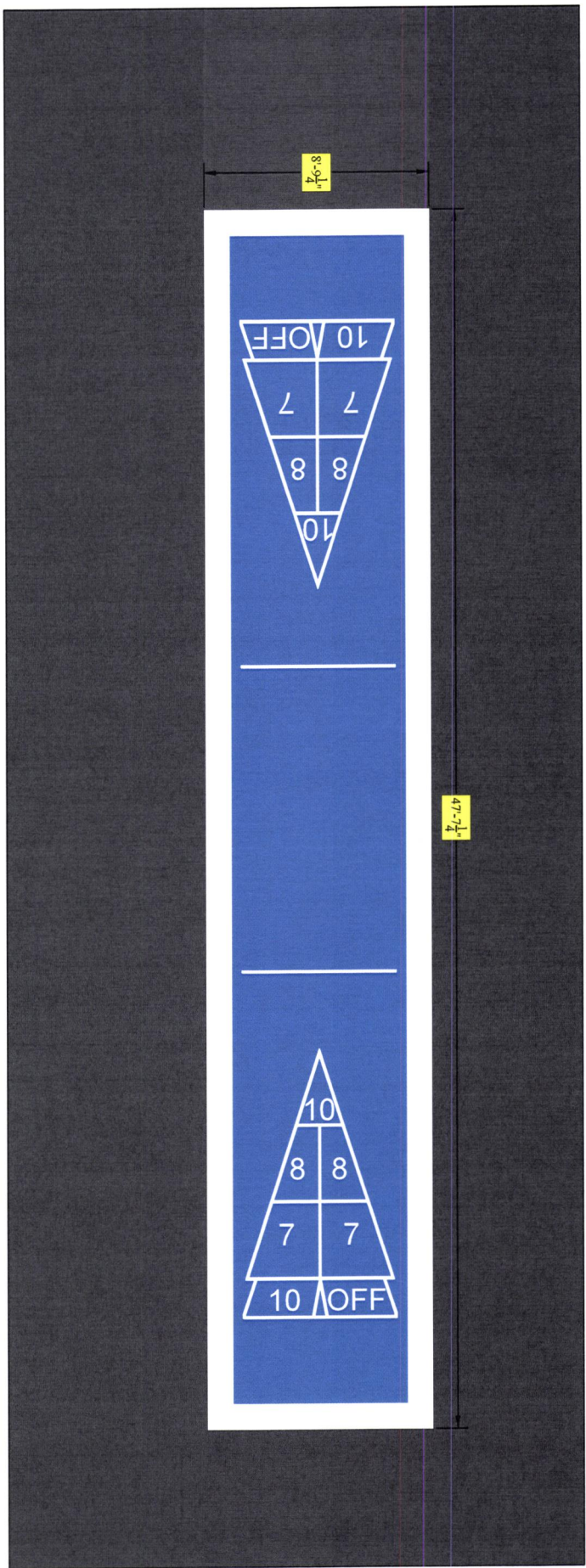

Signature: _____

Game Outdoor
These drawings are property of Versacourt, Inc. and shall not be released or distributed without written permission. Conceptual Drawing Only.
 SCALE: 1/4"=1'-0"

COLORS:
 Royal Blue/White
DRAWN BY:
 Saul Maldonado
CUSTOMER:
 City of Cambridge

Customer Approval
DATE:
 July 2019
SALESMAN:
 Jimmy Walker



STONE BASE SPEC

1. Mark court layout on the ground. Be sure to check for underground obstacles like sprinkler systems, power lines and septic systems. Also look for overhead obstacles like trees and overhead power lines.
2. Remove sod. Using a sod stripper remove the sod and save some to be used over the backfill around the court after the base is installed. Remove at least 2' beyond the forms to allow for tapering the backfill after the base is finished. A tiller can also be used and then organic material removed.
3. Compact ground. Using either a ride on roller or a plate compactor, compact the entire surface.
4. Set forms. The easiest way to set forms is to use a Laser Transit to set the height of the forms. The forms may be set level or at a .5% grade. If a grade is desired then make sure it is in the proper direction (ex. away from the house). Use 2'x6' treated lumber or an equivalent for forms.
5. Roll out and stake down Geotextile material (Mirafi HP750 or equivalent) using 6" sod stakes every 6'.
6. Add 2" – 3" crushed stone, 3/4" minus crusher run. If the ground is not level use the crushed stone as fill. Do not use soil as it will settle. After compacting this level you should be between 1" to 2" from the top of your forms.
7. Water and compact. Spray water over the crushed stone before compacting, this will help the stone compact better. If the stone is already wet watering may not be necessary.
8. Apply 1"-2" stone screenings 1/4" minus. Fill to the top of the forms.
9. Water and compact.
10. Level stone screening using the speed mover and drag mat (or other devices).
11. Use hand roller for final compaction.
12. Backfill around forms.
13. Once the stone screenings are smooth and level apply rubber matting.
14. VersaCourt tiles can then be assembled on top of the rubber mat.

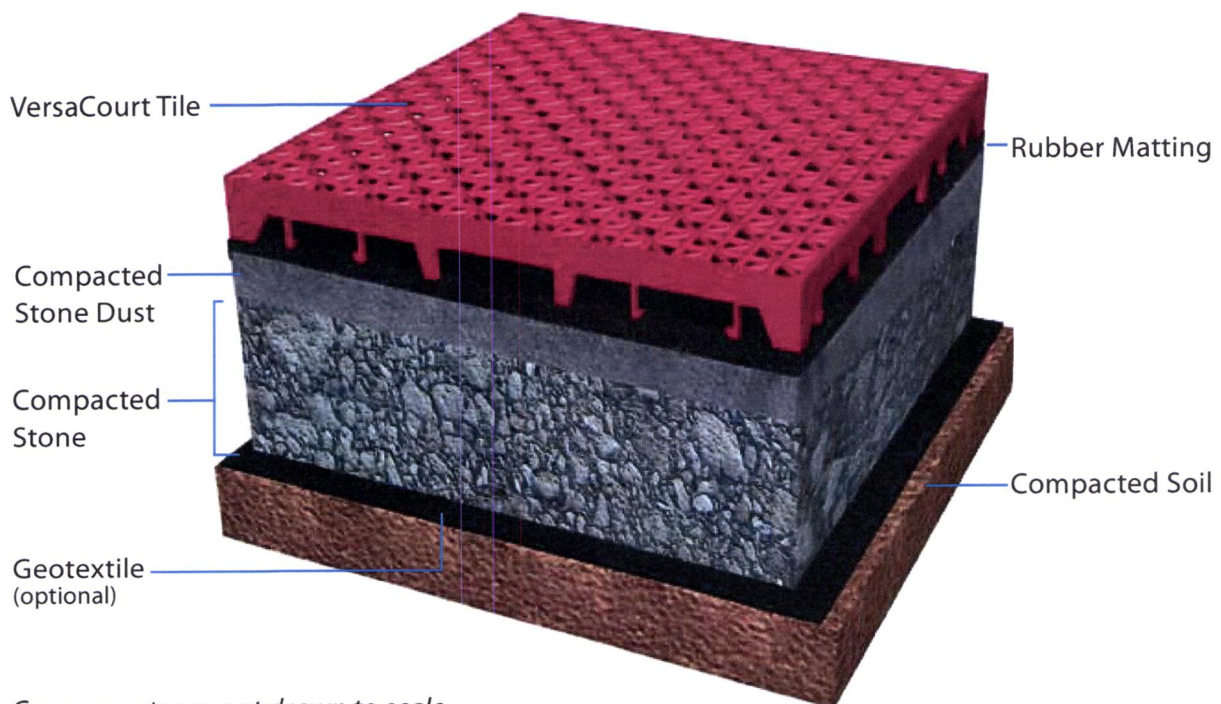

Components are not drawn to scale.



\$3000-

PowerScape 10' Swing

Model Number: 81600

\$ 2700⁻

Model View

Gallery





A PLAYCORE Company

Chest Press - Accessible



\$5300⁻

An accessible version of our popular Advanced Series Chest Press. Designed to look like the machines in a gym or fitness center, ours uses an exclusive variable resistance technology to provide the right amount of resistance for users of all fitness levels. The seat on one side and the accessible area on the other are both ergonomically-designed to provide users with the right...

Features and Benefits:

- Familiar-looking design makes it instantly recognizable to beginning and advanced users
- Utilizes our exclusive advanced variable resistance mechanism for smooth resistance throughout the range of motion
- Resistance mechanism is fully enclosed to protect from the elements and eliminates crush and shear...

Model: 13271i
Age Group: 13+ Years

Limited Lifetime Warranty on uprights, hardware and connections. Visit gametime.com/warranty for full warranty information



Designing award-winning playgrounds since 1929.



Certified Installer Network - GameTime trained for GameTime playgrounds.



Complies with ASTM standards before it leaves the factory.



A PLAYCORE Company

Accessible Parallel Bars

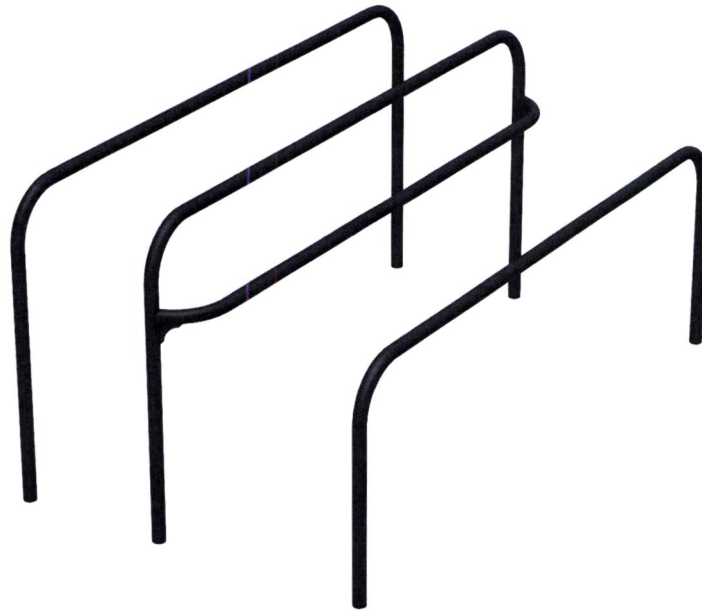

\$1400-

Developed in partnership with New York City Parks Department and physical therapists from Mount Sinai Hospital, the Accessible Parallel Bars allow adults who use a mobility device to perform upper body exercises alongside their peers.

The lower set of bars are 34" above the ground and designed for a user to pull him/herself and the mobility device into the bars. Grasping the...

Features and Benefits:

- Compact design shares space with standard parallel bars to promote inclusive fitness experience
- Designed with parks and recreation professionals and health professionals to ensure therapeutic effectiveness
- Provides an accessible, upper body workout
- Constructed of durable, recyclable materials and backed...

Model: 15504
Age Group: 13+ Years

Limited Lifetime Warranty on uprights, hardware and connections. Visit gametime.com/warranty for full warranty information



Designing award-winning playgrounds since 1929.



Certified Installer Network - GameTime trained for GameTime playgrounds.



Complies with ASTM standards before it leaves the factory.



A PLAYCORE Company

Cardio Walker



\$4100⁻



The Cardio Walker is an ideal solution for anyone seeking a low-impact aerobic workout in a park or along a fitness trail. Place your feet on the large slip-resistant platforms, grip the handlebar and move your legs forward and backward. The Cardio Walker provides an effective workout for people of all fitness levels.

Features and Benefits:

- A fun, low-impact aerobic workout for people of all fitness levels
- Wide handle bar allows users to grip the front or side of the bar for support during exercise
- Strengthens lower body muscles and improves cardio fitness
- Constructed of durable, recyclable materials and backed by the industry's leading...

Model: 13562i
Age Group: 13+ Years

Limited Lifetime Warranty on uprights, hardware and connections. Visit gametime.com/warranty for full warranty information



A PLAYCORE Company

Combination Hub



\$4100⁻

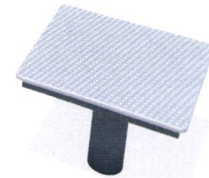

GTfit products help users build endurance and strength. Whether you are training for a sporting event or trying to achieve a greater level of functional fitness, these products are designed to strengthen the primary muscle groups that help users perform challenging tasks.

Features and Benefits:

Product requires impact attenuating surfacing to comply with ASTM F3101-15. Your GameTime representative will offer recommendations and products to meet these guidelines.

Model: 13590i
Age Group: 13+ Years

Limited Lifetime Warranty on uprights, hardware and connections. Visit gametime.com/warranty for full warranty information



Designing award-winning playgrounds since 1929.



Certified Installer Network - GameTime trained for GameTime playgrounds.



Complies with ASTM standards before it leaves the factory.



\$2600-

The Skill Trainer is designed to help enhance fine motor skills, coordination, flexibility and balance. It provides multiple exercise options, including the Finger Walk and Ring Trace. The Ring Trace includes three different heights (standing, seated on the included Comfort Seat or seated in a mobility device). Users grasp a colored ring and slide it from one side of the bar...

Features and Benefits:

- A great fitness option for the active aging community to enhance fine motor skills, balance and flexibility
- Ring Trace activity designed for three different height levels
- Includes Comfort Seat for users who prefer to sit during the exercise
- Constructed of durable, recyclable materials and backed by the...

Model: 14904
Use Zone: 7' X 7'
Age Group: 13+ Years

Limited Lifetime Warranty on uprights, hardware and connections. Visit gametime.com/warranty for full warranty information



Designing award-winning playgrounds since 1929.



Certified Installer Network - GameTime trained for GameTime playgrounds.



Complies with ASTM standards before it leaves the factory.



A PLAYCORE Company

Assisted Step Trainer

\$ 3000-

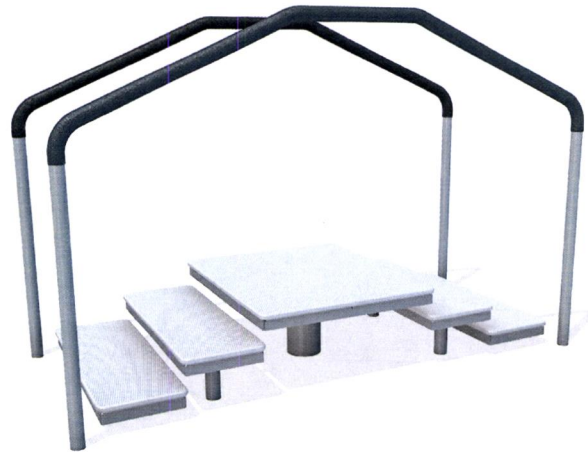

The Assisted Step Trainer provides users with an opportunity to enhance balance and flexibility and improve their functional fitness. The individual step platforms are constructed of sturdy HDPE plastic and feature a treaded surface for improved traction. The handrails include a ComfortGrip coating to make them easy to grasp while performing exercise. Users can ascend and...

Features and Benefits:

- Functional fitness station that enhances balance and flexibility
- Step platforms feature treaded surface for improved traction
- Hand rails include a coated surface for enhanced grip/grasp during exercise
- Constructed of durable, recyclable materials and backed by the industry's leading warranty
- Product...

Model: 14901
Use Zone: 7' X 6'
Age Group: 13+ Years

Limited Lifetime Warranty on uprights, hardware and connections. Visit gametime.com/warranty for full warranty information



Designing award-winning playgrounds since 1929.



Certified Installer Network - GameTime trained for GameTime playgrounds.



Complies with ASTM standards before it leaves the factory.



A PLAYCORE Company

Shoulder Rotator - Accessible



\$ 3800~

The accessible design of our Shoulder Rotator allows adults of all abilities to improve flexibility in their shoulder, arms and wrist - a great warmup option to begin your workout. Users grip the handles and rotate the discs with each arm, in the same direction or in opposing directions. The fully enclosed rotating mechanism is designed to provide smooth, fluid motion...

Features and Benefits:

- Provides an accessible flexibility workout station for adults of all abilities
- Rotating discs feature large grip handles and a fully enclosed rotation mechanism
- Constructed of durable, recyclable materials and backed by the industry's leading warranty

Model: 13558i
Age Group: 13+ Years

Limited Lifetime Warranty on uprights, hardware and connections. Visit gametime.com/warranty for full warranty information



Designing award-winning playgrounds since 1929.



Certified Installer Network - GameTime trained for GameTime playgrounds.



Complies with ASTM standards before it leaves the factory.



Minnesota / Wisconsin Playground
 5101 Highway 55, Suite 6000
 Golden Valley, Minnesota 55422
 Ph. 800-622-5425 | 763-546-7787
 Fax 763-546-5050 | info@mnwiplay.com

QUOTE
 #25980

08/21/2019

Individual exercise equipment - D9806B - Consultation

City of Cambridge
 Attn: Carri Levitski
 800 7th Avenue SW
 Cambridge, MN 55008
 Phone: 763-552-3257
 clevitski@ci.cambridge.mn.us

Ship To Zip: 55008

Quantity	Part #	Description	Unit Price	Amount
1	INSTALL	Install - Consultation for the installation of equipment, includes concrete footings. - <i>Owner to prepare site and make area flat and level for new equipment. MWP Installer will provide concrete and install footings and then the community build will install equipment. For the consultation the layout and drilling of footing holes should occur just one day prior to the consultation of the community build of the equipment. If the layout and drilling of holes cannot be one day prior, then additional costs may be incurred by the Owner due to mobilization and additional days.</i>	\$6,178.00	\$6,178.00

Owner is responsible for preparing the site to be level and flat for new surfacing and equipment. The consultation for the installation of equipment shall take place just one day after the layout and drilling of footing holes. The concrete will be provided by MWP. If the community build cannot occur just one day after the layout and rilling of footing holes the Owner may incur additional costs.

SubTotal: \$6,178.00
Total Amount: \$6,178.00

This quotation is subject to current Minnesota/Wisconsin Playground policies as well as the following terms and conditions. Our quotation is based on shipment of all items at one time to a single destination, unless noted, and changes are subject to price adjustment. Purchases in excess of \$1,000.00 to be supported by your written purchase order made out to Minnesota/Wisconsin Playground.

This quotation is subject to polices in the current Gametime Park and Playground catalog and the following terms and conditions. Our quotation is based on shipment of all items at one time to a single destination, unless noted, and changes are subject to price adjustment. Purchases in excess of \$1,000.00 to be supported by your written purchase order made out to Gametime, c/o Minnesota/Wisconsin Playground.

Pricing: f.o.b. factory, firm for 30 days from date of quotation. A tax-exempt certificate is needed at time of order entry for all orders whether from tax-supported government agencies or not. Sales tax, if applicable, will be added at time of invoice unless a tax exempt certificate is provided at time of order entry.

Payment terms: net 30 days for tax supported governmental agencies. Should this quotation be forwarded to an agency not listed on this quote, credit terms, as well as other terms and conditions herein, may be need to be altered. For instance, non-tax supported organization purchasing any or all products and/or services quoted herein may require full payment for that amount due at time of order entry. Remaining balance owed by tax supported agency, if any, shall still be net 30 days. A 1.5% per month finance charge will be imposed on all past due accounts. Equipment shall be invoiced separately from other services and shall be payable in advance of those services and project completion. Retainage not accepted.



City of Cambridge Council Members

Jim Godfrey, Mayor

Term – 01/07/2019 – 12/31/2023

763-552-3220

Lisa Iverson, Council Member

Term – 01/01/2017 – 12/31/2020

763-689-5399

Kersten Barfknecht-Conley, Council Member

Term – 01/01/2017 – 12/31/2023

763-331-4818

Bob Shogren, Council Member

Term – 01/07/2019 – 12/31/2023

763-245-6715

Vacant Seat, Council Member

This seat is planned to be appointed at the City Council Meeting on Monday, November 18, 2019

Additional Funders

Walker Levande – donation for equipment – donation unknown – pending

Affinity Plus Federal Credit Union – donation for equipment – donation unknown - pending



60' x 135'
Fitness
Equipment
Chest Press
Parallel Bars
Cardio Walker
Combination Hub
Skill Trainer
Step Trainer
Shoulder Rotater

45' x 60'
Double
Swingset
Wheelchair
Swing

Horseshoe Pits

Shuffleboard

Existing Trail

6th Ln SE

8th Ave SE

Reagan St S