

BEST MANAGEMENT PRACTICES FOR SMALL CONSTRUCTION SITES

Preserve existing vegetation

Preserve existing trees and vegetation where possible to prevent erosion.

Paint and Stucco

All paint and stucco materials stored on the site must be contained and covered. It is illegal for contractors to wash out paintbrushes in the street or dump any residues into the sewer or the storm drain. Paintbrushes and spray guns shall be washed/cleaned out into a hazardous materials barrel or put back into its original container and disposed of properly. Latex paint should be dried in its container and placed in the garbage. Oil paint and thinners need to be recycled as hazardous wastes. Keep extra absorbent materials and/or a wet/dry vacuum on site to quickly pick up unintended spills. Sites must also be checked and maintained daily. All chemicals and hazardous materials must be secured to prevent vandalism.

Perimeter Controls

Gravel and woodchip bags, silt fences, and fiber rolls are typical perimeter controls, and shall be used to surround the entire site. Replace any damaged perimeter controls immediately.

Building Materials / Staging areas

Building materials should always be covered when not in use to prevent runoff caused by wind or rain.

Dewatering Activities

A DNR permit may be required before dewatering during construction.

Storm Drains and Catch Basins

Storm drains must be protected at all times with perimeter controls, such as fiber rolls, filterbag inserts, or gravel bags.

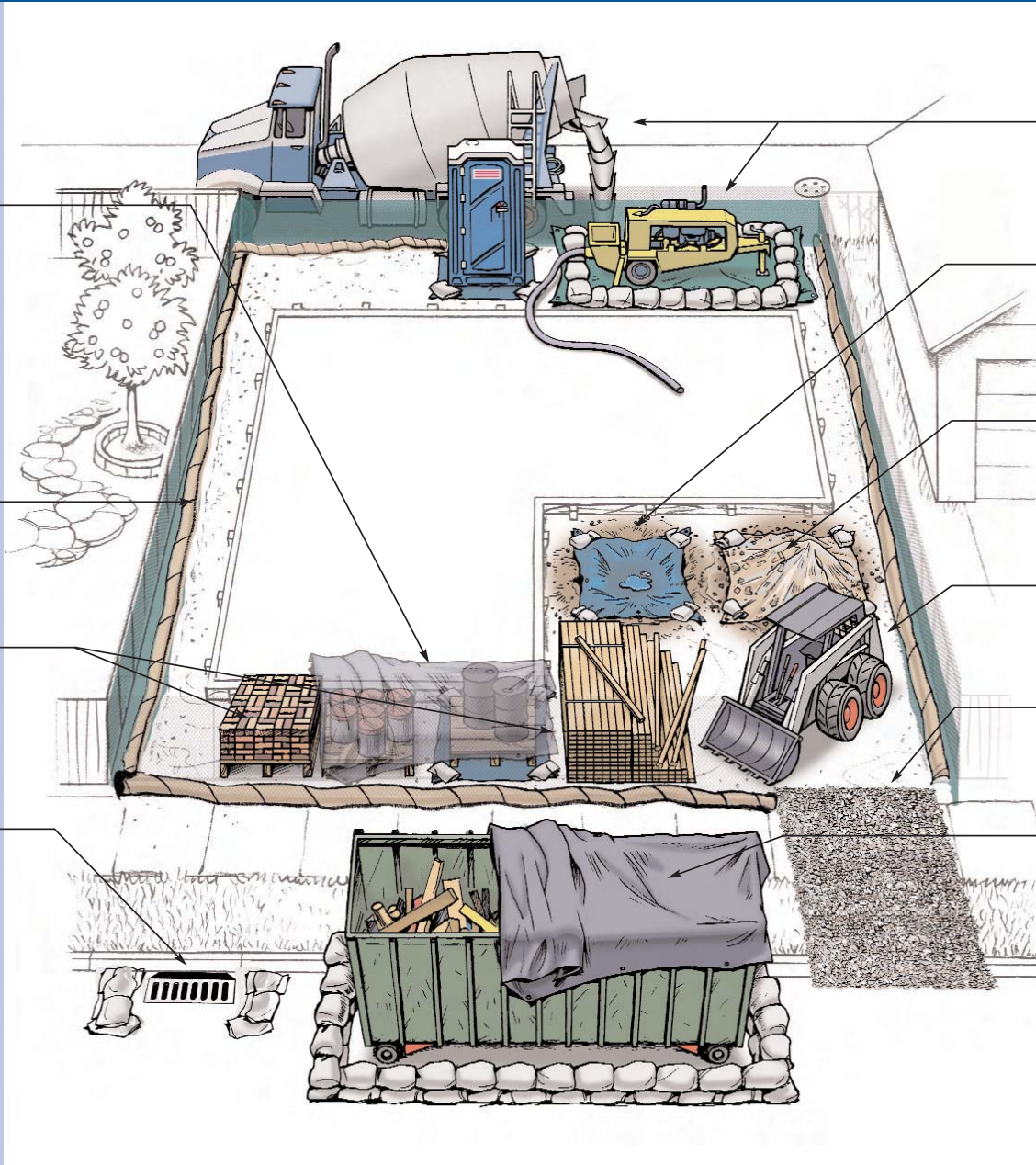

Concrete Trucks / Pumpers

Any concrete pumpers parked in public streets or alleys should be surrounded by perimeter controls, such as berms or fiber rolls. Tarps also should be placed beneath concrete pumpers at all times. Residual materials must be cleaned up as well.

Washout Area

The disposal of "wet" construction materials should be handled in the washout area or off-site. This includes stucco and concrete. Use an impervious tarp to line the bottom and prevent run-off in nearby areas. The washout area must be checked and maintained daily to ensure compliance.

Dirt and Grading

Mounds of dirt or gravel should be stored on site and covered each day with a tarp. When in use, all exposed dirt piles should be sprayed with water to prevent excessive dust. Tarps must be available and onsite to cover 125% of exposed areas. All stockpiles must have perimeter controls at all times.

Earthmoving Equipment

All earthmoving equipment should be stored onsite. Maintenance and repair should never be conducted on the site. All tracks and trails left by equipment leading to and from the site should be cleaned up immediately.

Construction site access drives

Access drives at any construction site should be made of mulch, wood chips or 3-4 inch rock with a geo-textile liner below the grade of the road. This is to be used by all vehicles to limit tracks of mud onto the streets.

Dumpsters

Keep dumpsters covered. Areas around dumpsters should be swept daily.